

CANNON ELECTRONICS
 S540-D (PROFESSIONAL)
 DECODER SECTION

4/15/72
 SHEET 2 OF 3

MOUNT TRANSISTORS
 3/32" ABOVE BOARD,
 ALL OTHER PARTS
 SOLIDLY AGAINST
 BOARD.

MOUNT DIODE WITH
 CATHODE BANDS UP.

MOUNT TANTALUM
 CAPACITORS WITH
 RED ENDS UP.

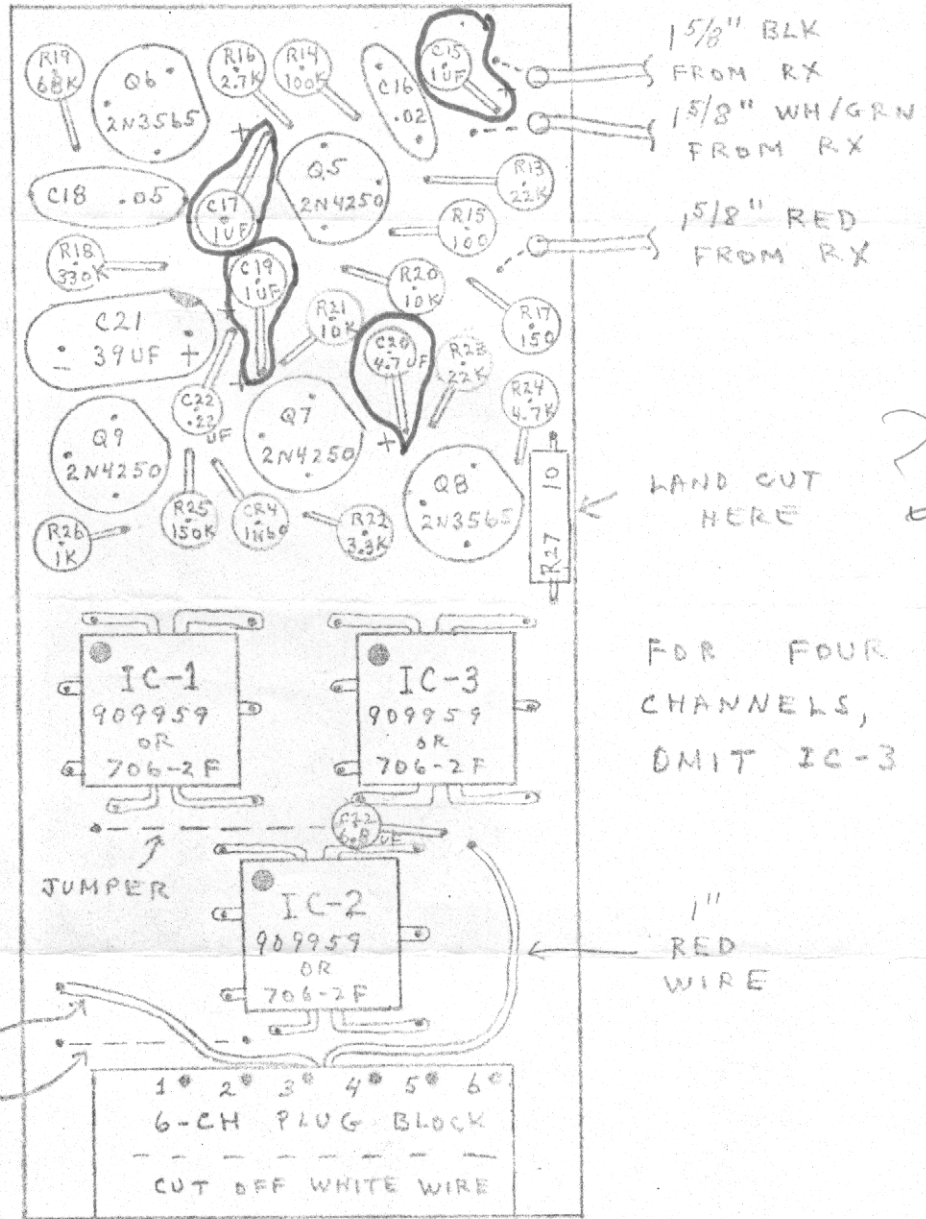

5/8" BLK FROM RX
 5/8" WH/GRN FROM RX
 5/8" RED FROM RX

LAND CUT HERE

FOR FOUR CHANNELS,
 OMIT IC-3

1" RED WIRE

5/8" BLACK WIRE

JUMPER

RX AND DECODER BOARDS
 FIT INTO SLOTS IN RX
 CASE WITH COMPONENTS
 FACING EACH OTHER.

DECODER

